

DATE: 12/15/54  
DRAWN BY: J. S. BROWN  
CHECKED BY: J. S. BROWN

DATE: 12/15/54  
DRAWN BY: J. S. BROWN  
CHECKED BY: J. S. BROWN

DATE: 12/15/54  
DRAWN BY: J. S. BROWN  
CHECKED BY: J. S. BROWN

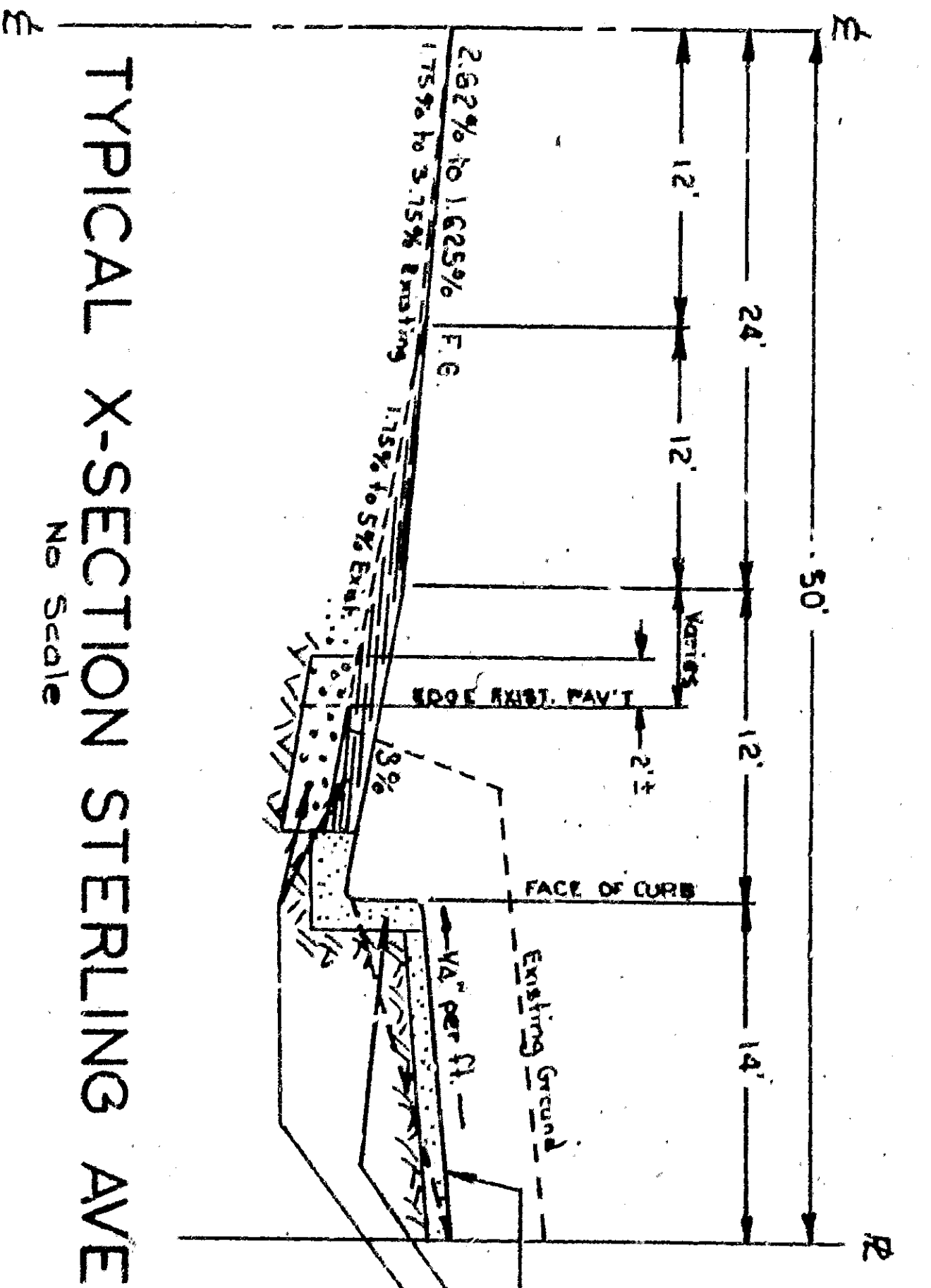
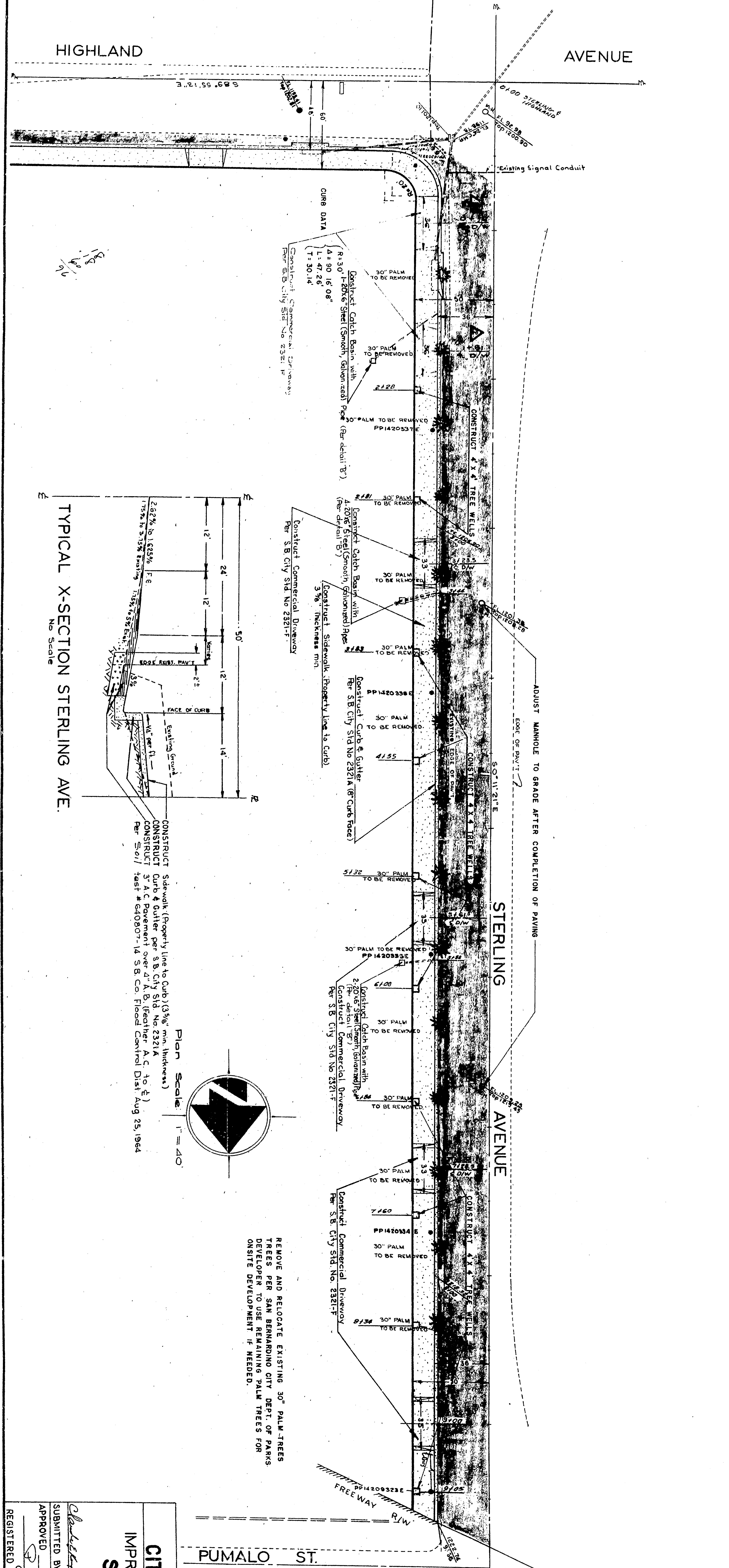


REMOVE AND RELOCATE EXISTING 30' PALM TREES  
TREES PER SAN BERNARDINO CITY DEPT. OF PARKS  
ON-SITE DEVELOPMENT IF NEEDED.

TRACT NO. 4600  
M 58/97  
ARGYLE AVE.

DEPARTMENT OF ENGINEERING  
CITY OF SAN BERNARDINO  
IMPROVEMENT PLAN & PROFILE  
STERLING AVENUE  
HIGHLAND AVENUE

APPROVED	1954	DRAWING NO.	3389
SUBMITTED BY	McNALL & KERR	CHECKED BY	J. S. BROWN
CITY ENGINEER	NO. 2425	SHEET	2
REGISTERED CIVIL ENGINEER		OF 2 SHEETS	



DATE: 12-15-66  
DRAWN BY: J.S. SMITH  
CHECKED BY: J.S. SMITH

DATE: 12-15-66  
DRAWN BY: J.S. SMITH  
CHECKED BY: J.S. SMITH

DATE: 12-15-66  
DRAWN BY: J.S. SMITH  
CHECKED BY: J.S. SMITH

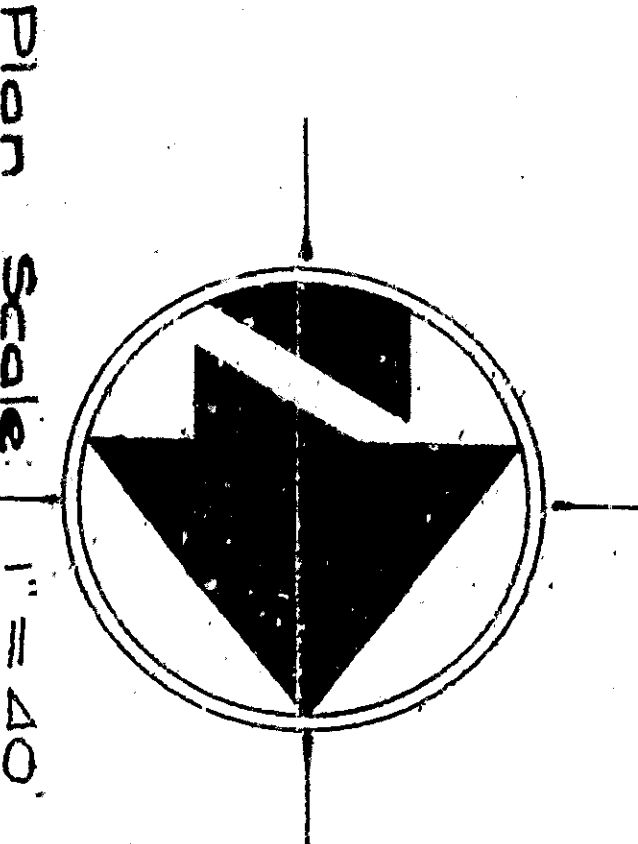
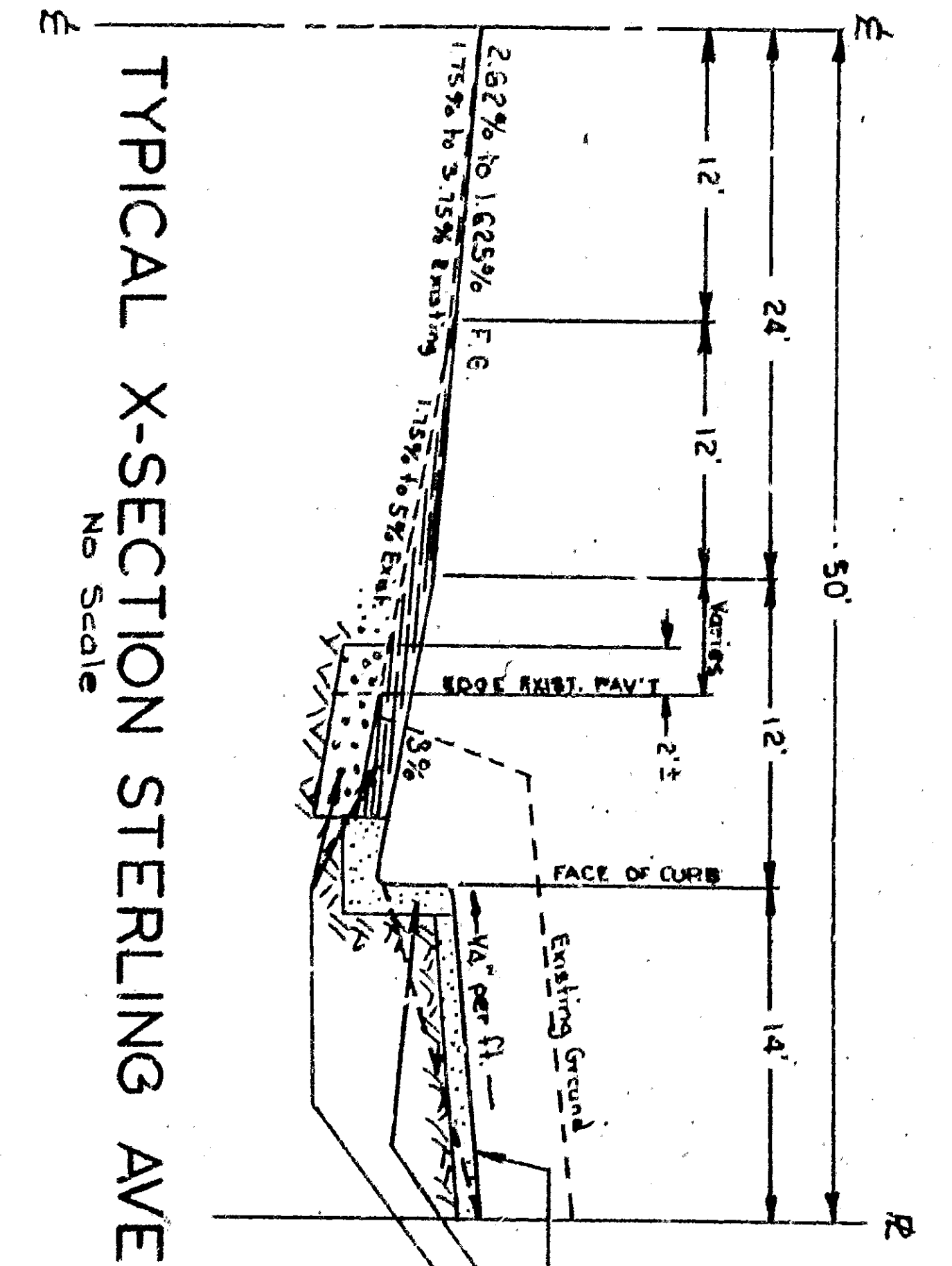
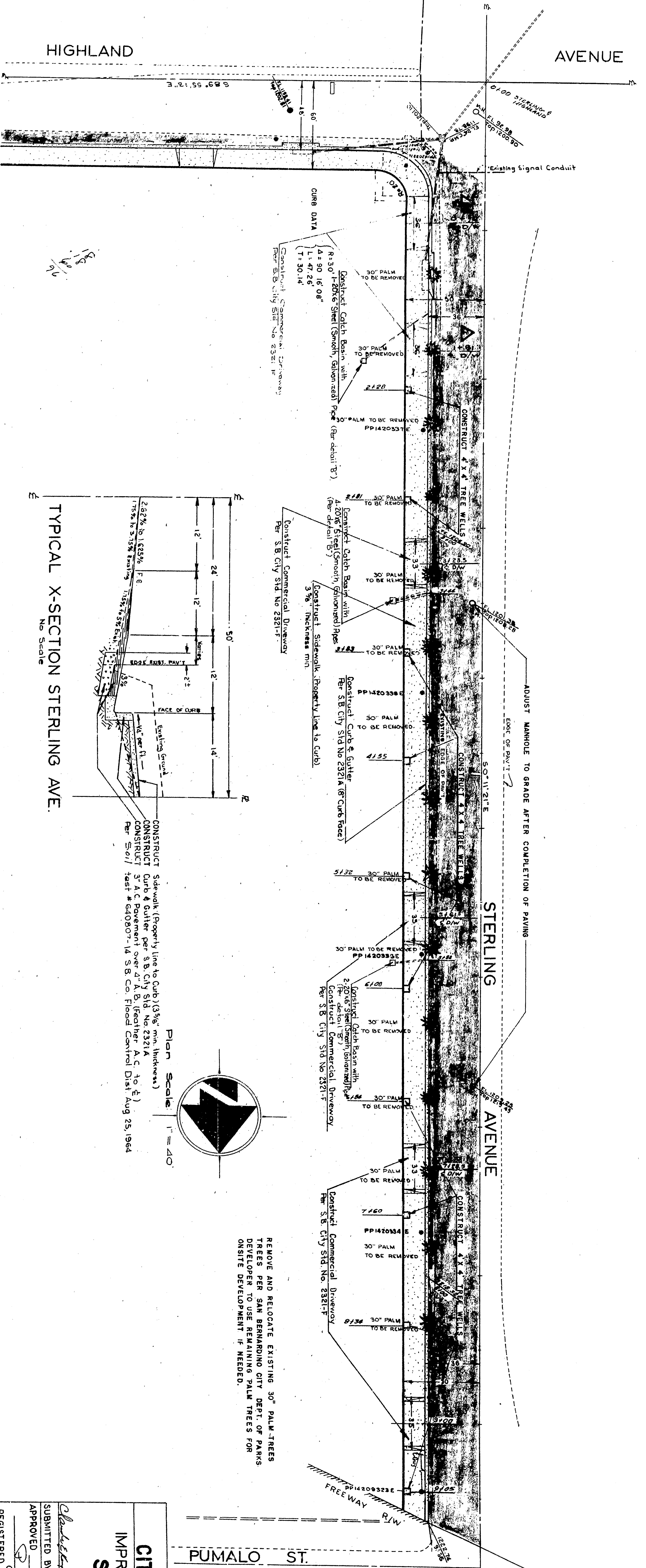


TRACT NO. 4600  
M 58/97  
ARGYLE AVE.

DEPARTMENT OF ENGINEERING  
CITY OF SAN BERNARDINO  
IMPROVEMENT PLAN & PROFILE  
STERLING AVENUE  
HIGHLAND AVENUE

APPROVED	1966	REFERENCE	DRAWING NO.
CITY ENGINEER	12-15-66	J.S. SMITH	3389
REGISTERED CIVIL ENGINEER NO. 24253		CHECKED BY	SHEET 2
			OF 2 SHEETS



DATE: 10/20/97  
DRAWN BY: JAS/SHH  
CHECKED BY: JAS/SHH  
REGISTERED CIVIL ENGINEER NO. 24523

DATE: 10/20/97  
DRAWN BY: JAS/SHH  
CHECKED BY: JAS/SHH  
REGISTERED CIVIL ENGINEER NO. 24523

DATE: 10/20/97  
DRAWN BY: JAS/SHH  
CHECKED BY: JAS/SHH  
REGISTERED CIVIL ENGINEER NO. 24523

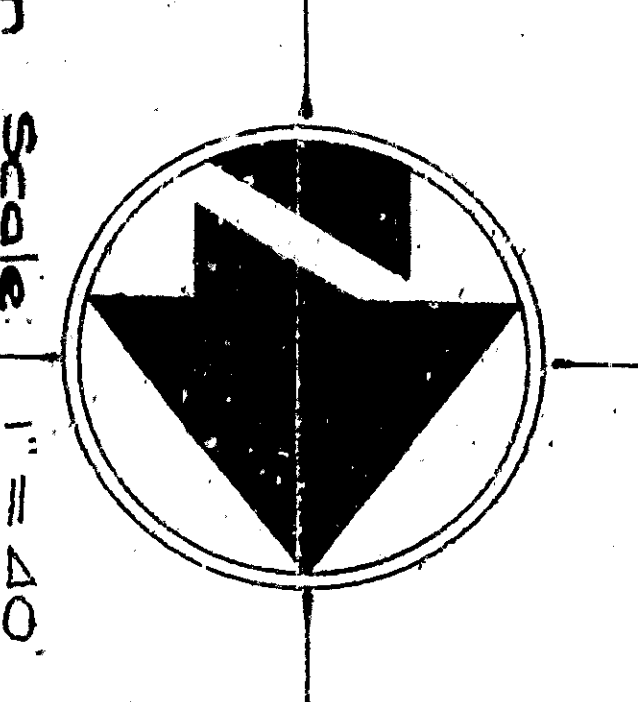
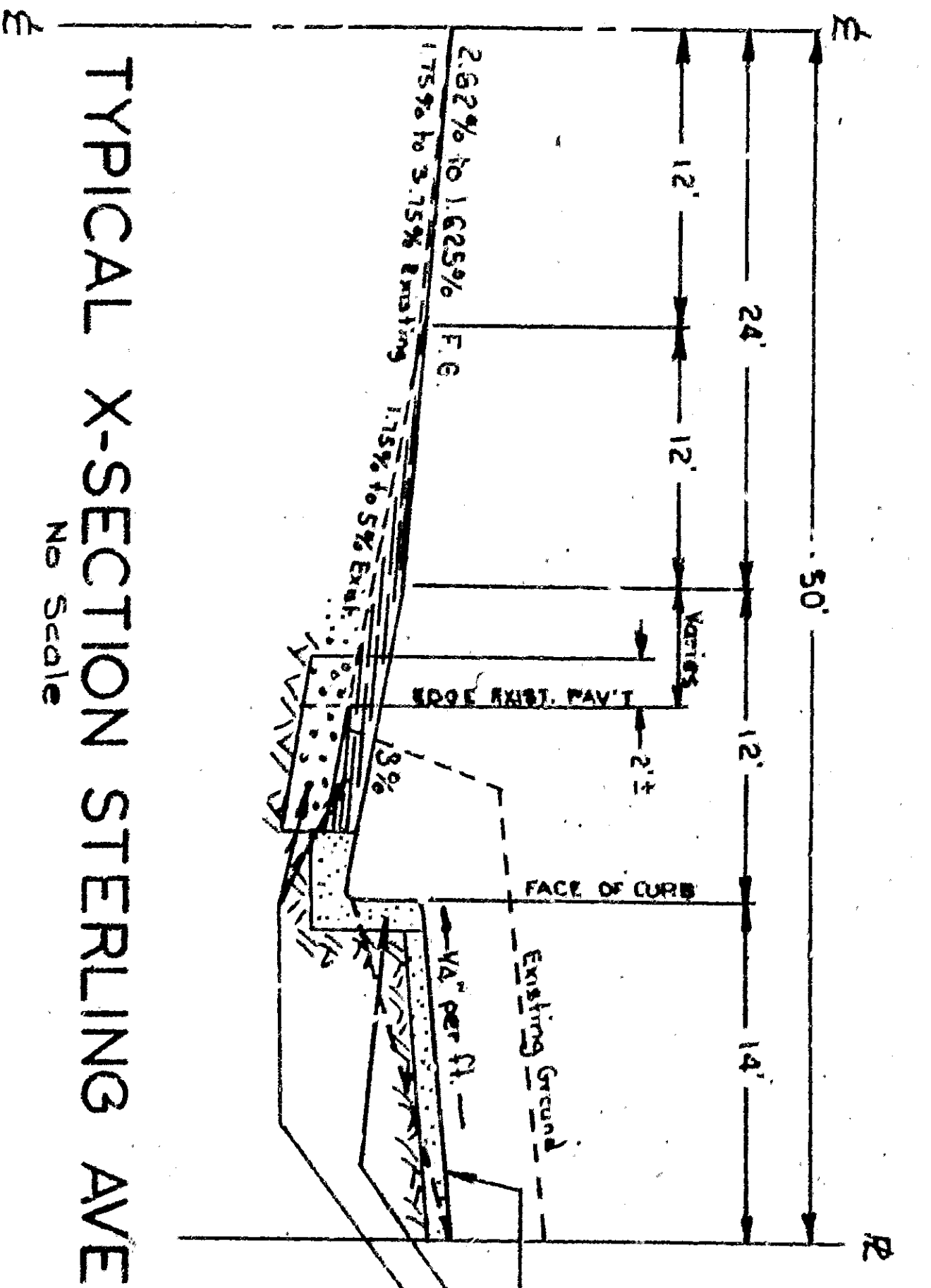
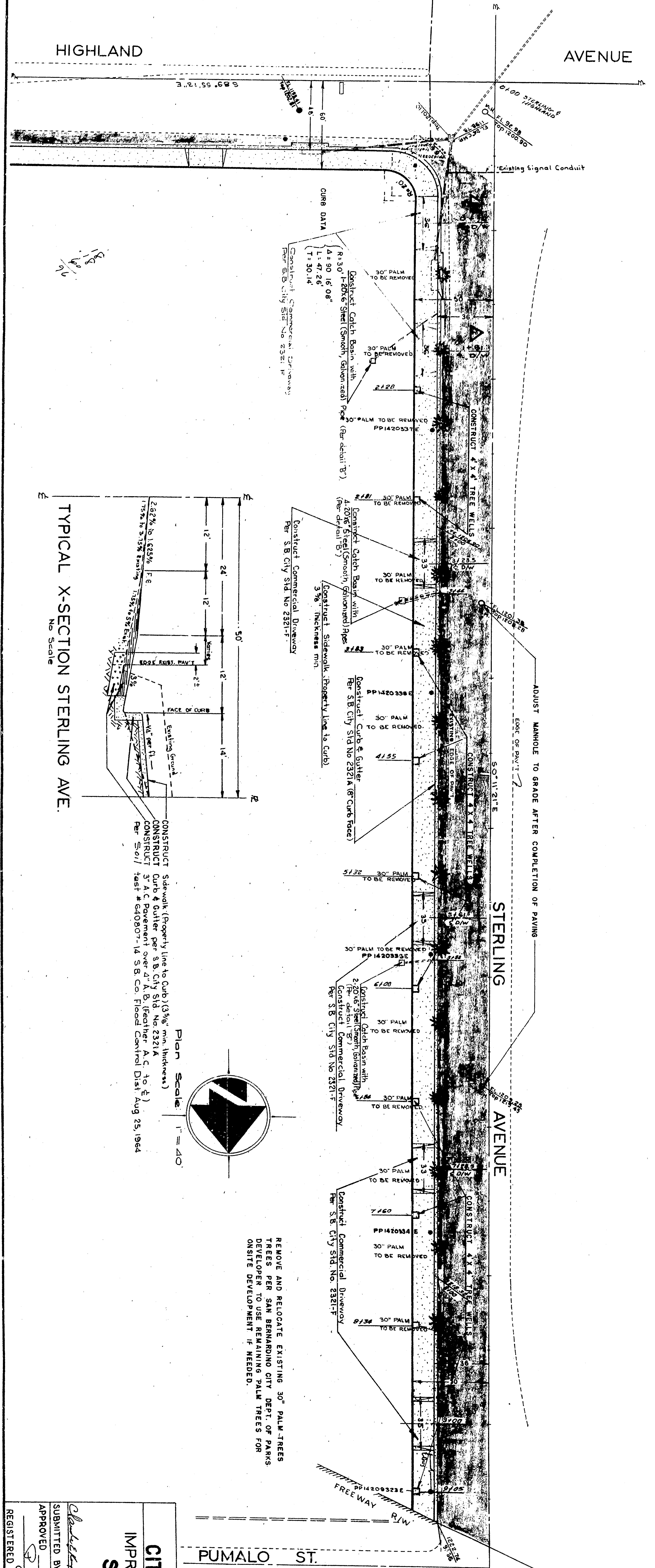
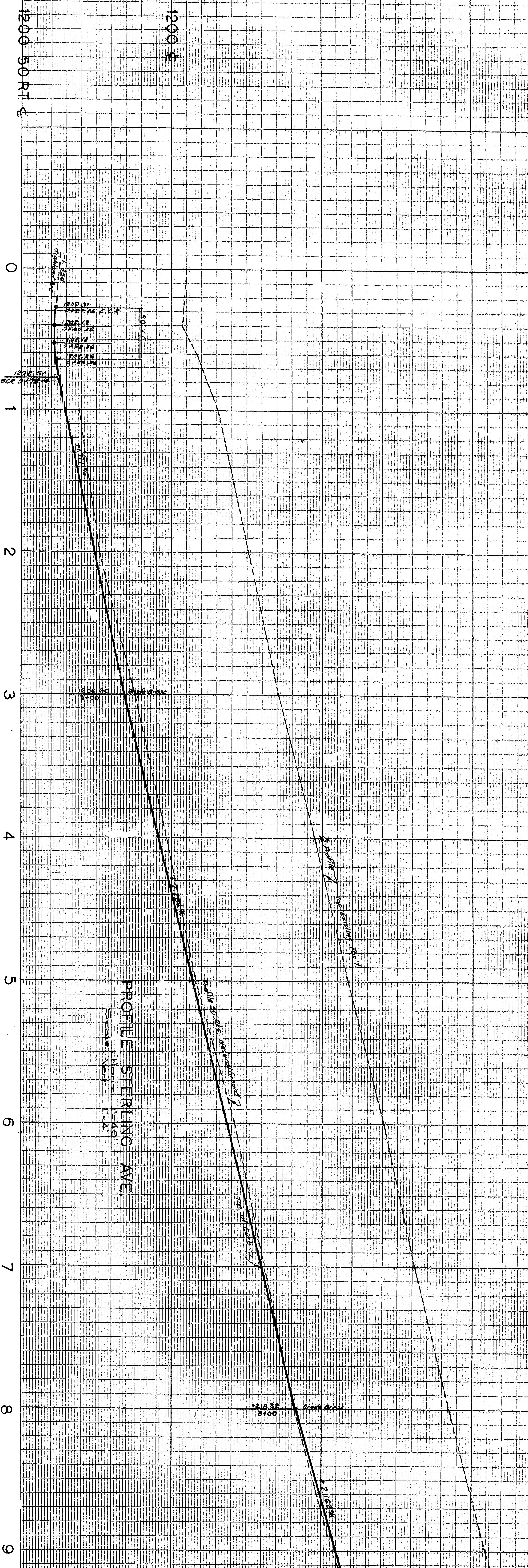

REMOVE AND RELOCATE EXISTING 30' PALM TREES  
TREES PER SAN BERNARDINO CITY DEPT. OF PARKS  
ON-SITE DEVELOPMENT IF NEEDED.

TRACT NO. 4690  
M 58/97

ARGYLE AVE.

DEPARTMENT OF ENGINEERING  
CITY OF SAN BERNARDINO  
IMPROVEMENT PLAN & PROFILE  
STERLING AVENUE  
HIGHLAND AVENUE

APPROVED	1976	REFERENCE	DRAWING NO.
DATE	12-6-95		3389
CITY ENGINEER		CHECKED BY	SHEET 2
REGISTERED CIVIL ENGINEER NO. 24523			OF 2 SHEETS